

REV	DESCRIPTION	DATE	APPROVED
S0	CREATED DRAWING	2026/06/27	CZW

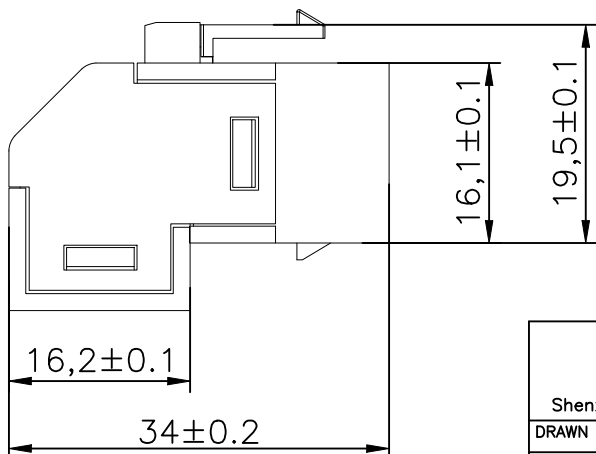

Electrical character

Rated voltage	/
Rated current	/
Mechanical characteristics (mating cycle)	>750
Degree of protection (ISO-20653,IEC60529)	/
Operating temperature (depending on cable quality)	-40°C +70°C
Destructive withstand force between connector and overmold exceeds	**kgf
Tightening torque (range)	/
Pollution degree	3
ALL MATERIALS ARE RoHS COMPLIANT	
PRODUCTS COMPLY WITH IEC61076-2-010	

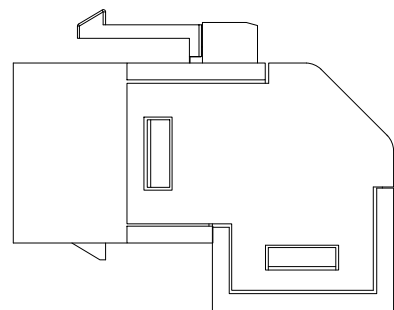
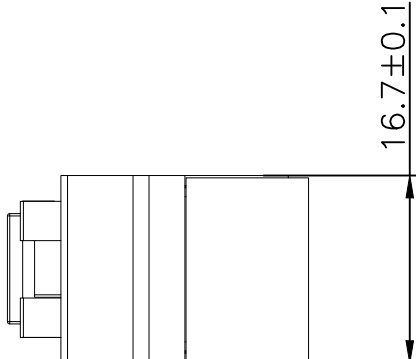
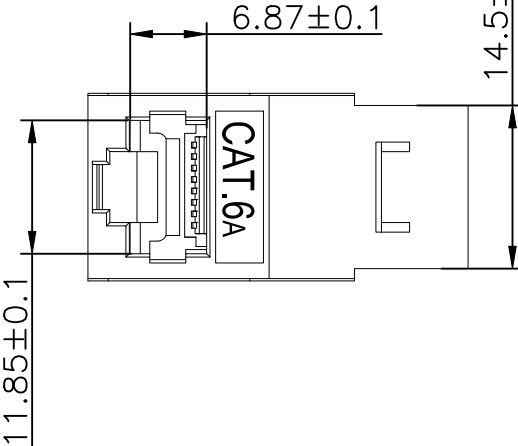
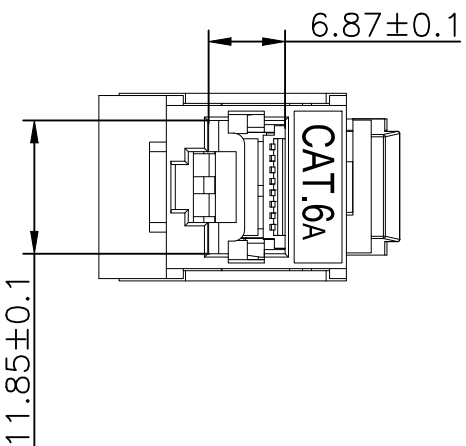

Shenzhen Signal Electronics Co., LTD

DRAWN BY	DATE
CHECKED BY	DATE
CHECKED BY	DATE
APPROVED BY	DATE

TITLE CAT6A SH 90° METAL FEED-THRU MODULE

SGN NO 940008-07-023 REV.

DWG NO

CUSTOMER

TOLERANCES ARE: DECIMALES ANGLES

.x ±0.5 x.* ±2.0°

.xx ±0.20 .x.* ±1.0°

THIRD ANGLE PROJECTION

SIZE: A4 UNITS: mm

SCALE: SHEET:

THE INFORMATION CONTAINED IN THIS DRAWING IS THE SOLE PROPERTY OF SIGNAL COMPANY. ANY REPRODUCTION IN PART OR WHOLE WITHOUT THE WRITTEN PERMISSION OF SIGNAL COMPANY IS PROHIBITED.