

RECOMMENDED
PANEL CUT-OUT

Electrical character

Rated voltage	SEE TABLE
Rated current	SEE TABLE
Mechanical characteristics (mating cycle)	>100
Degree of protection (ISO-20653, IEC60529)	IP67
Operating temperature (depending on cable quality)	-40°C +80°C
Destructive withstand force between connector and overmold exceeds	**kgf
Tightening torque (range)	/
Pollution degree	3
ALL MATERIALS ARE RoHS COMPLIANT	
PRODUCTS COMPLY WITH IEC61076-2-010	

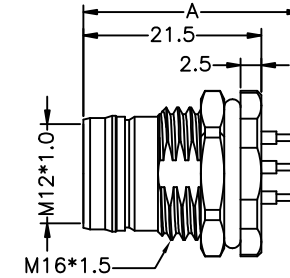
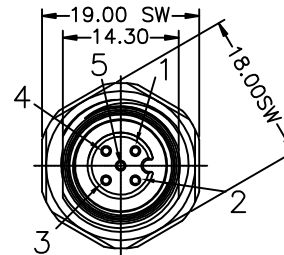

TABLE 1:

Part Number	Contacts	KEY NAME	Rated voltage		Rated current	Contacts	SIZE A
			A/C	D/C			
120404-04-189		D	250V	250V	4A	4	26.3
120104-04-173		A	250V	250V	4A	4	26.3
120105-04-214		A	60V	60V	4A	5	26.3
120108-04-212		A	30V	30V	2A	8	26.3
120112-04-108		A	30V	30V	1.5A	12	26.3

REV	DESCRIPTION	DATE	APPROVED
S0	CREATED DRAWING	2025/11/11	WJY

 Shenzhen Signal Electronics Co., LTD		TITLE M12 FEMALE CONNECTOR END, PUSH-PULL SELF-LOCKING (EXTERNAL LOCK)	
		SGN NO	N/A
DRAWN BY	DATE	DWG NO	REV.
CHECKED BY	DATE	CUSTOMER	S0
CHECKED BY	DATE	TOLERANCES ARE:	
APPROVED BY	DATE	DECIMALES	ANGLES
<small>THE INFORMATION CONTAINED IN THIS DRAWING IS THE SOLE PROPERTY OF SIGNAL COMPANY. ANY REPRODUCTION IN PART OR WHOLE WITHOUT THE WRITTEN PERMISSION OF SIGNAL COMPANY IS PROHIBITED.</small>		.x ±0.5	x.* ±2.0°
		.xx ±0.20	.x.* ±1.0°
		THIRD ANGLE PROJECTION	
		SIZE: A4	UNITS: mm
		SCALE:	SHEET: