

REV	DESCRIPTION	DATE	APPROVED
S0	创建图纸	2022/09/21	CHZ
S1	更新图纸	2022/11/01	CHZ
S2	更新图纸	2023/06/26	XD

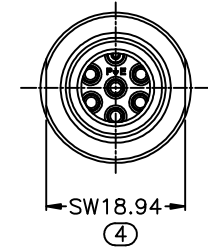

Electrical character

Rated voltage	630V AC/DC
Rated current	14A
Mechanical characteristics (mating cycle)	>100
Degree of protection (ISO-20653,IEC60529)	IP67
Operating temperature (depending on cable quality)	-25°C ~ +85°C
Destructive withstand force between connector and overmold exceeds	**kgf
Tightening torque (range)	0.4~1.8Nm
Pollution degree	3
*ALL MATERIALS ARE RoHS COMPLIANT*	

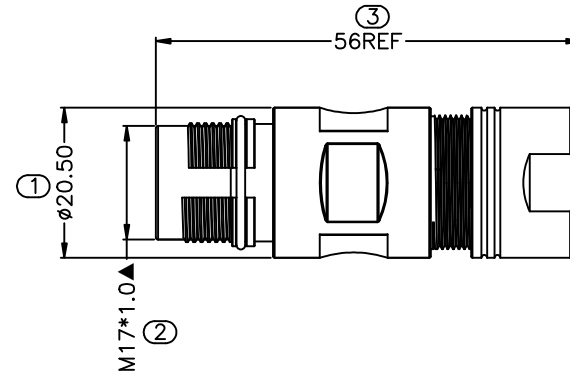
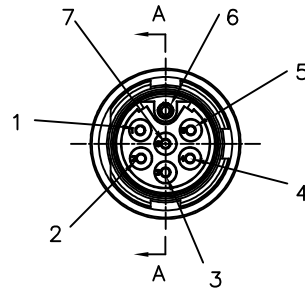
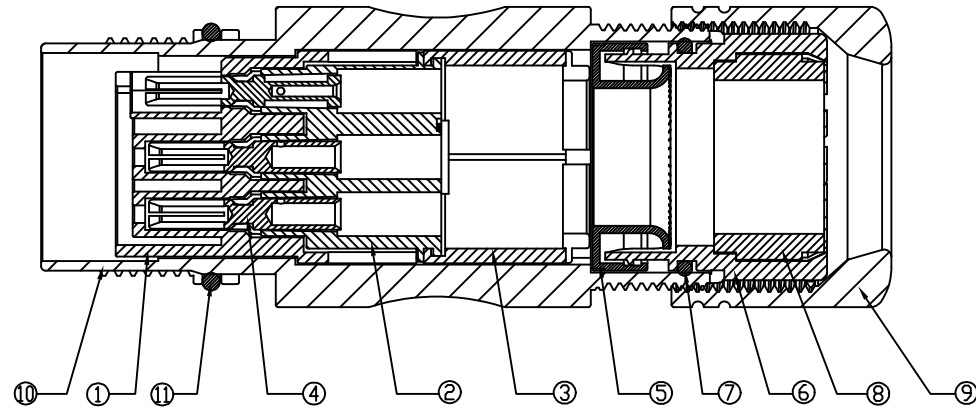

截面A-A  
2:1

⑪	OR00209	O-Ring BLACK EPDM 70A OD=14.8*1.2mm	1	PCS
⑩	WK00857	M17 BRASS PLATED NICKELOU STRAIGHT ASSEMBLY FEMALE SHELL L=46.5mm	1	PCS
⑨	NU00196	M17 BRASS PLATED NICKELOUSTAIL NUT $\phi$ 20.5*15mm	1	PCS
⑧	OR00281	M17 TAIL SEAL RING GREEN FKM $\phi$ 14* $\phi$ 10.5mm	1	PCS
⑦	OR00306	GREEN O-Ring FKM $\phi$ 14.0*1.0mm	1	PCS
⑥	CN01291	M17 METAL STRAIGHT TAIL SIX CLAWS PA66 BLACK	1	PCS
⑤	CN01409	M17 RIVETED COPPER PLATED NICKELOUS TAIL CIRCLIP	1	PCS
④	TE01445	M17 9P RIVETED COPPER PLATED GOLD 1u" CRIMP FEMALE TERMINAL $\phi$ 1.0*13.1mm	7	PCS
③	CN01408	M17 9P STRAUGHT METAL ASSEMBLY NYLON CLIP L=11.3mm	1	PCS
②	CN01411	M17 7P ASSEMBLY F/M NYLON REAR HOUSING L=14.3mm	1	PCS
①	CN01417	M17 7P ASSEMBLY FEMALE NYLON FRONT HOUSING L=20.5mm	1	PCS
ITEM	PART NO.	SPECIFICATION	Q'TY	UNIT

 Shenzhen Signal Electronics co.,Ltd		TITLE M17 7PIN FEMALE METALASSEMBLY CONNECTOR	
		SGN NO 170007-02-001	REV. S2
DRAWN BY	DATE	DWG NO	
CHECKED BY	DATE	CUSTOMER	
CHECKED BY	DATE	APPROVED BY	
APPROVED BY		DATE	
<small>THE INFORMATION CONTAINED IN THIS DRAWING IS THE SOLE PROPERTY OF SIGNAL COMPANY. ANY REPRODUCTION IN PART OR WHOLE WITHOUT THE WRITTEN PERMISSION OF SIGNAL COMPANY IS PROHIBITED.</small>		TOLERANCES ARE: DECIMALES .x $\pm$ 0.20 ANGLES .x' $\pm$ 2.0° .xx $\pm$ 0.10 .x' $\pm$ 1.0°	THIRD ANGLE PROJECTION 
		SIZE: A4	UNITS: mm
		SCALE: 1:1	SHEET: 1 OF 1