

REV	DESCRIPTION	DATE	APPROVED
S0	创建图纸	2022/09/15	CHZ
S1	更新图纸	2022/11/01	CHZ
S2	更新图纸	2023/06/26	XD

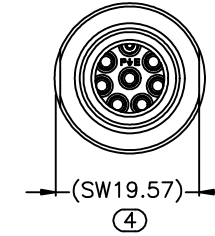

Electrical character

Rated voltage	630V AC/DC
Rated current	14A
Mechanical characteristics (mating cycle)	>100
Degree of protection (ISO-20653, IEC60529)	IP67
Operating temperature (depending on cable quality)	-25°C ~ +85°C
Destructive withstand force between connector and overmold exceeds	**kgf
Tightening torque (range)	0.4~1.8Nm
Pollution degree	3
ALL MATERIALS ARE RoHS COMPLIANT	

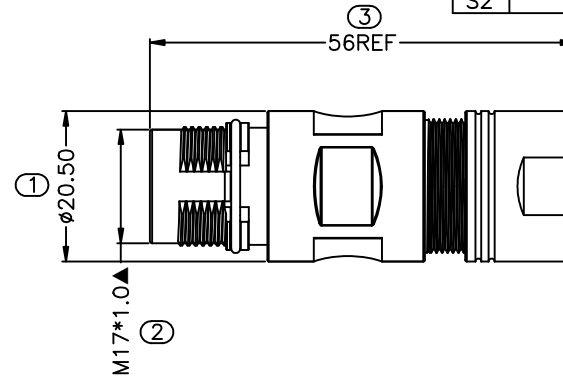
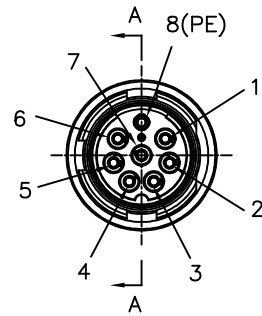
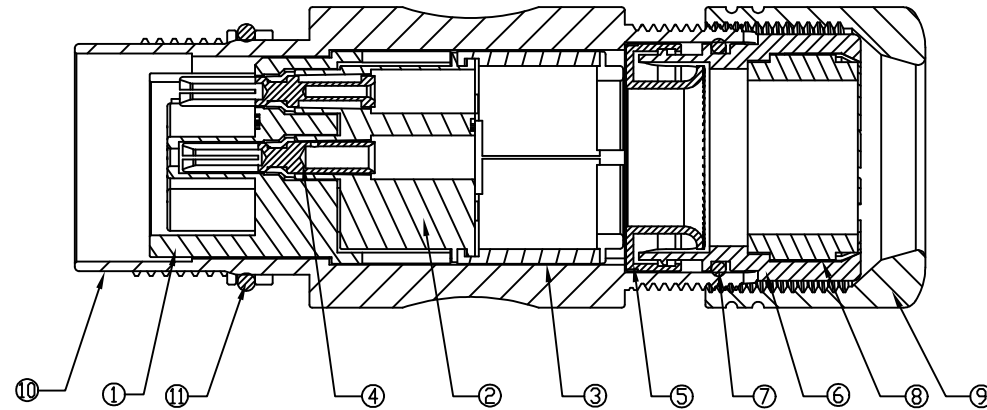

截面A-A
2:1

ITEM	PART NO.	SPECIFICATION	Q'TY	UNIT
⑪	OR00209	O-Ring BLACK EPDM 70A OD=14.8*1.2mm	1	PCS
⑩	WK00857	M17 BRASS PLATED NICKELOUS STRAIGHT ASSEMBLY FEMALE SHELL L=46.5mm	1	PCS
⑨	NU00196	M17 BRASS PLATED NICKELOUS TAIL NUT ϕ 20.5*15mm	1	PCS
⑧	OR00281	M17 TAIL SEAL RING GREEN FKM ϕ 14* ϕ 10.5mm	1	PCS
⑦	OR00306	GREEN O-Ring FKM ϕ 14.0*1.0mm	1	PCS
⑥	CN01291	M17 METAL STRAIGHT ASSEMBLY TAIL SIX CLAWS PA66 BLACK	1	PCS
⑤	CN01409	M17 RIVETED COPPER PLATED NICKELOUS ASSEMBLY TAIL CIRCLIP	1	PCS
④	TE01445	M17 9P RIVETED COPPER PLATED GOLD 1u" CRIMP FEMALE TERMINAL ϕ 1.0*13.1mm	8	PCS
③	CN01408	M17 9P STRAIGHT METAL ASSEMBLY NYLON CLIPL=11.3mm	1	PCS
②	CN01413	M17 8P ASSEMBLY F/M REAR NYLON HOUSING L=14.3mm	1	PCS
①	CN01418	M17 8P ASSEMBLY FEMALE NYLON FRONT HOUSING L=20.5mm	1	PCS

SIGNAL[®]
Shenzhen Signal Electronics co.,Ltd

DRAWN BY	DATE
CHECKED BY	DATE
CHECKED BY	DATE
APPROVED BY	DATE

TITLE
M17 8PIN FEMALE ASSEMBLY CONNECTOR

SGN NO	170008-02-001	REV.
DWG NO		
CUSTOMER		S2

TOLERANCES ARE:		THIRD ANGLE PROJECTION	
DECIMALES	ANGLES	SIZE: A4	UNITS: mm
.x \pm 0.20	x.' \pm 2.0'	SCALE: 1:1	SHEET: 1 OF 1
.xx \pm 0.10	.x' \pm 1.0'		