

REV	DESCRIPTION	DATE	APPROVED
S0	CREATED DRAWING	2022/08/04	CHZ

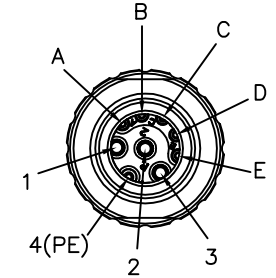
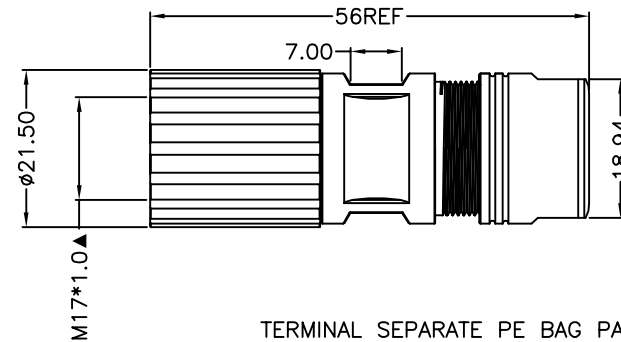
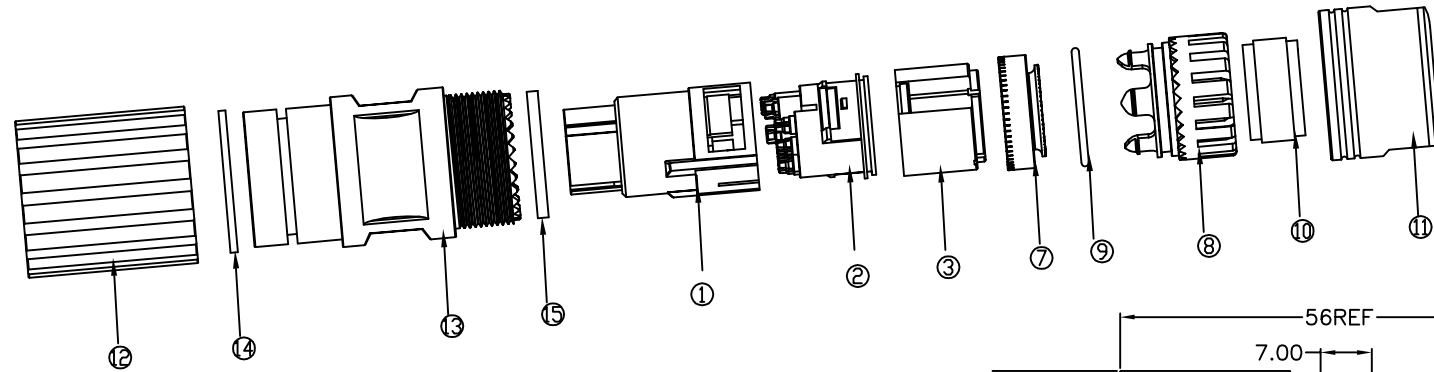

DETAILED PRODUCT DESCRIPTION:
 WATERPROOF CONNECTOR RATING IS IP67
 THEY CAN NOT BE USED PERMANENTLY UNDER WATER
 PER ISO-20653, IEC60529

ELECTRICAL PROPERTIES AT +20°C
 RATING VOLTAGE: 60/630V AC/DC
 INSULATION RESISTANCE: >100MΩ
 RATING CURRENT: 3.6/14A
 CONTACT RESISTANCE OF CONNECTOR ≤5mΩ
 MECHANICAL CHARACTERISTICS: MATING CYCLE >100 CYCLES
 OPERATING TEMPERATURE: -25°C ~ +105°C

ALL MATERIALS ARE ROHS COMPLIANT

TERMINAL SEPARATE PE BAG PACKAGING ILLUSTRATION:

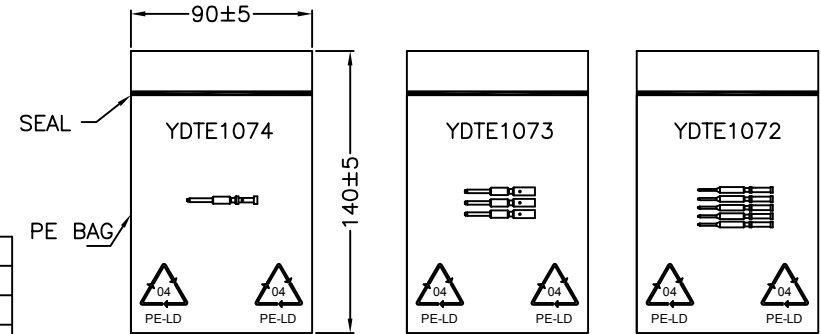

15	YDOR0209	M17 9PIN GREEN WATERPROOF RING	1	PCS
14	YDWJ0168	M17 9PIN MALE CIRCLIP	1	PCS
13	YDWK0685	M17 BRASS WITH NI PLATING FEMALE SHELL L=36.5mm	1	PCS
12	YDNU0138	M17 BRASS NICKEL PLATED COUPLING NUT Ø21.5X23.2MM	1	PCS
11	YDNU0137	M17 BRASS NICKEL PLATED TAIL NUT Ø20.5X15MM	1	PCS
10	YDOR0206	M17 9PIN REAR SEAL RING	1	PCS
9	YDOR0208	M17 GREEN O-RING Ø14.2X1.0mm	1	PCS
8	YDCN0874	M17 BLACK TAIL SIX CLAWS (PA66)	1	PCS
7	YDCN0873	M17 BRASS NICKEL PLATED TAIL COLLAR	1	PCS
6	YDTE1074	M17 RIVETED COPPER GOLD PLATED 1U" MALE TERMINAL, Ø1.0MM (PE)	1	PCS
5	YDTE1073	M17 RIVETED COPPER GOLD PLATED 1U" MALE TERMINAL, Ø1.0MM	3	PCS
4	YDTE1072	M17 RIVETED COPPER GOLD PLATED 1U" MALE TERMINAL, Ø0.6MM	5	PCS
3	YDCN0872	M17 9PIN BLACK BUCKLE (PA66) L=11.3mm	1	PCS
2	YDCN0871	M17 9PIN WHITE MALE REAR HOUSING (PA66+GF)	1	PCS
1	YDCN0875	M17 9PIN BLACK MALE FRONT HOUSING (PA66+GF)	1	PCS
ITEM	PART NO.	SPECIFICATION	Q'TY	UNIT

 SIGNAL [®] Shenzhen Signal Electronics co.,Ltd		TITLE	
		M17 9PIN MALE METAL ASSEMBLED CONNECTOR	
DRAWN BY		DATE	SGN NO
CHECKED BY		DATE	170009-01-001
CHECKED BY		DATE	CUSTOMER
APPROVED BY		DATE	REV.
THE INFORMATION CONTAINED IN THIS DRAWING IS THE SOLE PROPERTY OF SIGNAL COMPANY. ANY REPRODUCTION IN PART OR WHOLE WITHOUT THE WRITTEN PERMISSION OF SIGNAL COMPANY IS PROHIBITED.		TOLERANCES ARE:	THIRD ANGLE PROJECTION
		DECIMALES	ANGLES
		.x ±0.50	x.' ±2.0'
		.xx ±0.20	.x' ±1.0'
		SIZE: A4	UNITS: mm
		SCALE: 1:1	SHEET: 1 OF 1